

More Information at www.aquacentrum.com/eos-genesis-9-cell-waterionizer

Genesis Platinum

ALKALINE WATER IONIZER



- Computer Controlled Smart Ionization**
- One-touch Operation**
- Alarm signal Messaging**
- Digital Filter Change Indicator**

Genesis Platinum

ALKALINE WATER IONIZER

- Make sure to carefully read this User Manual before using this product. (Keep the manual handy for easy reference.)
- This product is intended for domestic use. To ensure proper use, make sure to read the User Manual.
- **Make sure you read "Safety Warnings" to ensure proper use.**

- Manufacturing No. 1134 Approved by Korea Food & Drug Administration
 - Item No. 08-763 Approved by Korea Food & Drug Administration



Alkaline water ionizer

Table of CONTENTS

To our customers:

- ▶ Thank you for purchasing one of our products.
- ▶ This product is approved by Korea Food & Drug Administration as a medicinal device for the purpose of medical treatment.
- ▶ Make sure to carefully read this manual to ensure proper use of the product.
- ▶ If you have any inquiries during use, or in the event that this product doesn't function properly, refer to this manual.
- ▶ We assume no responsibilities for any accidents that occur out of improper use of this product as specified in the manual.
- ▶ Keep the manual and the warranty in a safe place so you can refer to it as needed.

Prior to Using this Product

Precautions before Use 2
 Safety Precautions 3~8

Direction

Product Features 9~10
 Description of Product 11~13
 Installation Directions 14
 Directions for Using this Product 15~18
 Filter Replacement 19~20
 Uses and Applications 21~22

Service Information

Safety Precautions 23
 Product Specifications 24
 Checklist before Requesting After-Sales Service 25
 Product Warranty 26

Product Warranty

1. This product is warranted for a period of one year (12 months). Additional warranty may be offered on a separate sheet from this manual. In the case where any manufacturing defects or spontaneous failures occur during the warranty period, we will offer repair or replacement services at no charge.
2. If any failure occurs, contact us.
3. In the following cases, the customer shall pay repair or replacement costs.
 - In the case where a failure occurs resulting from improper use or carelessness
 - In the case where repairs or modifications are made by our company's non-authorized representative
 - In the case where a failure occurs due to force majeure (fires, salt damage, damage from gas, earthquakes, floods, lightning, etc.)
 - In the case of absence of the product warranty or in the case where no information is provided in the warranty
4. We shall charge the customer for the repair or replacement costs against failures occurring past the warranty period (one year after the date of purchase, unless additional warranty is offered on a separate form)
5. Our customers are asked to show their warranty to us when requesting after-sales service.
6. This warranty shall not be reissued. Make sure to keep it in a safe place.

MODEL NAME		
SERIAL NO.		
DATE		
ADDRESS		
NAME		TEL

.....
 We cannot accept any responsibility or liability for errors and/or problems arising from the customer's use of parts that aren't manufactured by our company.

Manufacturing Company : EOS HITECH CO., LTD
 MADE IN KOREA

Things to be confirmed before requesting after-sales service

Before requesting after-sales service, be sure to check the following:

Symptoms	Checkpoints	Measures to be Taken
Water tastes abnormal	Check the product for the period of use,	Operate the product so that it should be drained of stagnant water for one minute.
	Check the filter for replacement time intervals,	Request that the filter should be replaced.
No water outflow Amount of water generated different from specified	Check if the valve on the raw water supply line is closed,	Open the valve.
	Check if the hose is bent or folded,	Stretch out the hose.
	Check if flow rates are low (1ℓ /min or slower)	Contact our A/S center to install a water pump.
	Check if water supply is cut off or if the water supply line is frozen,	Wait until water comes out of the water supply pipe.
Incorrect pH levels (pH samples are provided on a fee-for-service basis)	Check the purifying filter for being clogged,	Request that the filter should be replaced.
	Check water for solidity,	Depending on regions and water quality, pH levels may vary.
	Check flow rates for higher levels,	Reduce the amount of raw water.
The filter replacement icon remains turned on even after the filter has been replaced.	Check if the amount of water drained is small,	Set the system. (Request for after-sales service).
	Check if the filter flow rate is initialized,	- Initialize the filter flow rate in the System Setting Mode. - Request for after-sales service.
The product automatically stops while it is producing reduction water.	Check if the continuous operating time exceeds 5 minutes.	Water production is automatically stopped in 10 minutes in order to prevent water outflow due to user's carelessness.
Leaks from the filter or product	Check the filter for proper mounting,	Immediately deplug the power cord and request for after-sales service.
	Check for the inside of the product with the exception of the filter for any leaks	
Hazy substance settles down on the bottom of the bottle filled with reduction water	Check if calcium ions and carbonic acids bond together in water, forming deposits.	Depending on raw water quality, calcium minerals in raw water are extracted. There is no problem in drinking the calcium minerals in water. However, it is recommended that the customer should request for after-sales service to protect the product units in the case where such calcium minerals are generated in a continuous manner.
Only purified water is extracted	Check if the flow rate is low (1kgℓ/㎩ or slower)	Contact our A/S center to install a pressurized pump.
	Check if the flow rate is high (5kgℓ/㎩ or faster)	Contact our A/S center to install a pressure-reducing valve.
The product doesn't operate in Cleaning Mode	Check if the amount of working water exceeds 30ℓ .	
	Check if the operating time exceeds 12 hours.	The product returns to the normal condition after performing auto cleaning for 15 seconds.

Precautions before Use

Precautions before Use



When you begin drinking alkaline water, start with "Alkali 1" for the first month. If no negative symptoms occur, then gradually increase the level of alkaline water to "alkali 2" for the next month. After your body has become acclimated to "Alkali 2", then you can progress to your final step of "Alkali 3".
WARNING – DO NOT DRINK "ALKALI 4", IT IS FOR SPECIAL USE. SEE PAGE 21 OF MANUAL.



Don't take medicine with alkaline water. When taking medicine, use purified or filtered water.



A person who suffers from achlorhydria should not drink alkaline water. (Please consult your physician.)
Achlorhydria refers to an abnormal deficiency or absence of free hydrochloric acid in the gastric juice, often associated with severe anemias and cancer of the stomach.



The person who falls under one of the following categories should consult his/her doctor or pharmacist prior to drinking alkaline water. (Please consult your physician.)



1. A person who is a carrier of a chronic disease;
2. A person who has a disorder of the liver and bowels;
3. A person who is being treated under his/her doctor's prescription;



It is recommended that you use tap water as source water. (Don't use well water as source water if possible.) (For customers who want to use well water as source water, contact our service center.)

CAUTION : This appliance is not intended for use by persons (including children) with reduced physical, sensory or mental capabilities, or lack of experience and knowledge, unless they have been given supervision or instruction concerning use of the appliance by a person responsible for their safety. Children should be supervised to ensure that they do not play with the appliance.

Safety precautions are provided for the safe and proper use of this product and prevent unexpected danger or possible damage. Make sure you are familiar with the safety precautions for the proper use of the product.

-  The "DANGER" sign indicates an imminent hazard that, if not avoided, will result in serious injury or death.
-  The "WARNING" sign indicates a potential hazard that, if not avoided, will result in significant injury to the body or damage to property.
-  The "ATTENTION" sign indicates a potential hazard that, if not avoided, will result in minor injury to the body or damage to property.

Power Supply Precautions

 Do not use a damaged power cord or loose connector, electric shock or fire may occur.

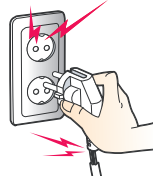

 Do not pull the power cord. Do not touch it with wet hands, otherwise, electric shock or fire may occur.

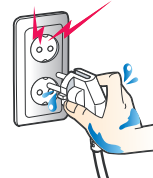

 Do not forcibly bend the power cord and make sure the power cord isn't squeezed, damaged or deformed by heavy things. Otherwise, electric shock or fire may occur.

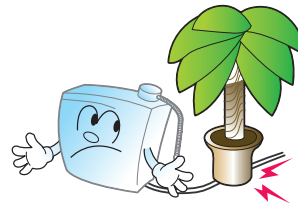

 In the event that water gets into the power supply unit, pull the power cord and make it completely dry prior to use. Otherwise, electric shock or fire may occur.



Item		Specifications
Model Name		Genesis Platinum
Rated Power Supply		AC 100V-120V or AC 220V-240V / 50-60Hz
Water Supply Method		Direct connection to tap water
Body	Dimension	340*340*150 (H×W×D)mm
	Packing Unit	1Set
Allowable water pressure		1.5~5.0 kgf/cm ²
Allowable Temperature		5~40 °C
Electrolysis Device	Electrolysis Method	Continuous Electrolysis
	Generating Capacity	1.1~3.5ℓ/min
	Electrolysis Step	Alkaline water: 4 step / Acid water: 4 step
	Electrolysis cleaning	Automatic cleaning(cleaning time: approx. 30 seconds)
	Electrode	9Plate Platinum/Titanium
Purification Device	Filter replacement	Cartridge type (pair type)
	Filter lifetime	First-phase filter : 4,000ℓ, Second-phase filter : 8,000ℓ
	Lifetime indication	Letter indication on LCD
	Filter materials	Three-layered sediment filter, granular activated carbon, Ceramic ball

Beware of the following

1. Never Modify the unit at your will
 2. Never use or store this unit in a place with extreme temperatures or dampness
 3. Use this unit first checking the rated voltage.
 4. Immediately stop using this unit if you find the machine is malfunctioning.
 5. In the event that you are not feeling well from drinking the water or the problem can not be released even after continuous use of the ionic water, stop further use of the water and consult doctor.
 6. Do not use ionic water with medicine.
 7. People of achlorhydria is not applicable to have ionic water
 8. In the beginning start with a low pH level and work your way up to higher pH level.
 - Never use as described below
 - A place water is easy to be frozen
 - A place fire may be contacted directly
 - Water of high hardness(pre filter needed – contact service center)
 - Never use with water of over 80 degrees
 - Never use water as described below
 - Water reagent was put in for testing pH
 - Water immediately after changing filter (use water after water flow for 2-3min).
In case using water after machine has been sitting for a long time (use water after water flow for 2-3min).
 - Store alkaline ionic water in a plastic container in airtight condition within one day.
Do not use a metal container (except stainless steel) to store alkaline ionic water since active state may be lost when contacting with air
- ※ If the supply cord is damaged, it must be replaced by the manufacturer, its service agent or similar qualified persons in order to avoid a hazard
- ※ When the source water supply is cut off the power plug must be unplugged.



During product repair/inspection and/or parts replacement, be sure to unplug the power cord, otherwise, electric shock or fire may occur.

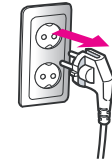

Use a dedicated connector per outlet for each electrical product. Otherwise, electric shock or fire may occur.

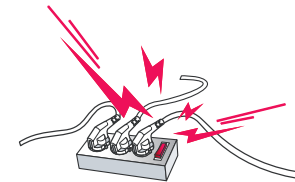

Do not separate, sever or splice the power cord. Otherwise, electric shock or fire may occur.

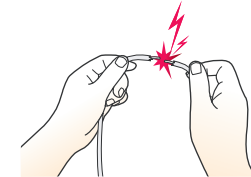

Do not plug and unplug the power cord repeatedly. Otherwise, electric shock or fire may occur.

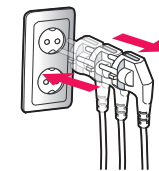

In the case of a damaged power cord, do not replace it with another one. Contact our customer service to get a new power cord. Otherwise, electric shock or fire may occur.

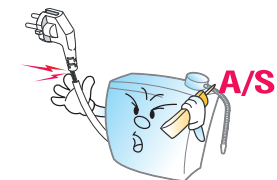

Usage



In the case where source water isn't used over a long period, lock the source water valve and pull the power cord out. Otherwise, electric shock, fire or leaks may occur.

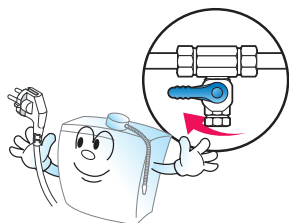

Never poke or scratch the touch screen with a sharp object, this may cause electric shock or damage to the product. (Give a light touch to the touch screen.)

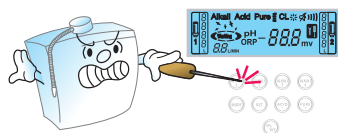

If alkaline water is used over a long period of time, some problems may occur in the product. In such situations, use acidic water. The same holds true for the opposite case.

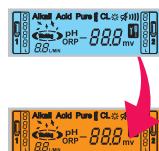

During the humid summer months, it is normal for condensed water can flow out of the product. However, it is not normal for condensed water to flow out of the product during the cold months. If this occurs please contact customer service.



Direction for Alkaline Water Storage

- Alkaline water should be stored in glass, china wear or stainless steel all of which have excellent resistance to corrosion.
- Keep alkaline water in a sealed container within the refrigerator. This alkaline water is available for use up to three days.

Special Acidic Water Usage

- Burns and stanching : Acidic water delivers excellent styptic characteristics. As such, if cut wounds and/or burns are soaked directly in acidic water, or if a poultice is applied to them, good results may be obtained.
 - Gargling and respiratory diseases: In the case of a sore throat or heavy cough, gargle with acidic water for positive results.
 - Athlete's foot For a person who has athlete's feet, soak the affected area of the foot in acidic water for about twenty minutes per day.
 - To help disinfect in the kitchen: Soak tableware, cutting board, dish towel, etc. in strong acidic water for about 20 to 30 minutes.
 - Flower arrangement: Apply one part acidic water diluted with two part of water to the cut portion of the flower. The flower will remain fresh for a longer time.
 - Bathing, face washing, and shampoo: When washing, use acidic water that will be good for skin care. Acidic water can act as an astringent that makes your skin elastic, and that prevents chloasma, pimple, and freckles from occurring (your skin is lightly acidic by nature.) If you rinse your hair with acidic water after shampoo, the alkalinity of your soap will be neutralized and your hair will have a good shine. The acidic water (astringent) used after shaving can be used as skin lotion for disinfection and as an astringent.
- ※ Astringent refers to an acidic cosmetic lotion that tends to draw together or constrict soft organic tissue.

Make sure to be well familiar with storage and special usage to enjoy better effects in your daily life.

Direction for Alkaline Water Application

Drink alkaline water 2 to 3 cups per day as drinkable water. If there are no negative symptoms, you are recommended to drink alkaline water at higher pH levels.

NOTE: Drinking Alkaline water for the first time may possibly cause slight nausea or other symptoms until your body gets acclimated to it. Please gradually allow your body to get acclimated by drinking lower PH levels first. If you any symptoms persist, cease drinking the water and consult with your physician.

Special Alkaline Water Usage

- When cooking rice: Before getting rice ready to cook, wash rice with acidic water and soak it in alkaline water for 30 to 60 minutes. When the rice is completely cooked, it becomes cooked ion rice that has a good polish just as cooked glutinous rice, that tastes good, and maintains freshness for a longer period of time.
- Coffee, tea, etc. Removes the bitterness of coffee and the astringency of tea while giving fragrance to both coffee and tea.
- Soak fresh meat and astringent vegetables in alkaline water for 20–30 minutes to remove the smell of fat (from meat) and makes both the meat and vegetables taste better.
- To maintain freshness, wash vegetables and fruit with alkaline water for longer lasting freshness.
- Alkaline water may be good for hangovers when taking it before going to sleep or when the stomach is empty in the morning.
- An ice cocktail in alkaline water makes your taste softer and smoother.
- Try to cook bamboo shoots, tree sprouts, taros, and brown seaweeds through the use of alkaline water. The burning pungency of those food ingredients will be eliminated, and their unique taste will be retained. In particular, alkaline water eliminates the fishy smell when used in cooking with fish.
- Animal distemper: Alkaline water has a good effect on infectious diseases (caries fever) occurring in puppies and filaria, making animal furs look beautiful and facilitating development. In particular, alkaline water has increased the egg-laying rate of chickens while making meat more tasty by inhibiting the growth of fat.

Usage



Do not place a vessel filled with water, pharmaceuticals, food, or small metals on this product, if introduced into the product, this may cause electric shock or fire.

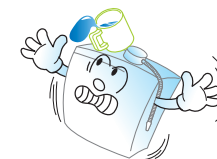

In the event that abnormal noise, a burning smell, or smoke is generated from the product immediately unplug the power connector and contact our customer service department. Otherwise, fire or damage to the unit may occur.



In the event that water flows from inside of the product, or water is present around the product, lock the source water valve, pull out the power cord, and contact over service center.

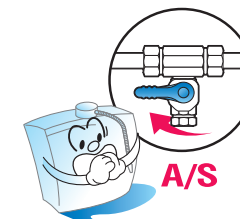

Replace filters according to the filter replacement cycles to ensure clean water. If a filter that has reached the end of its life cycle is still in use, purifying performance and product life can be degraded. (Replacement cycle: primary filter: 6months, secondary filter: 12months) Even though the filter replacement indicator lamp isn't turned on, replace filters every 6 months to maintain the purifying performance of this product.



Cleaning



Disconnect the power cord before cleaning. Do not spray water directly onto the power cord, do not clean it with benzene or thinner. This may cause electric shock, fire or damage to this product.

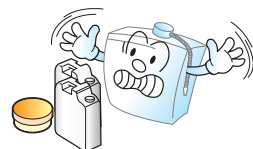

benzene or thinner..... Danger



Be sure to dry water thoroughly on and around the power cord and on the prong before reconnecting to the electrical outlet.

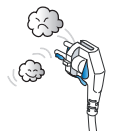

Do not spray water onto the machine directly, use a damp cloth to clean the outside casing. Never wet or clean inside of the machine. Otherwise, a short circuit or electric shock may occur. (In the case where the LCD gets contaminated, clean it with a damp cloth.)



Others



When moving the machine to another place, do not drag the machine by the power cord, this may cause electric shock or fire.

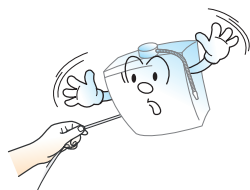

Do not disassemble or refurbish this product at your discretion. Otherwise, electric shock or damage to the product may occur (voiding warranty).

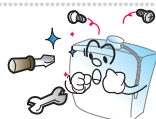

Use purified or filtered water, (not alkaline or acidic water), for fish tanks/bowls.



- ⑤ Install the first and second-phase filter into the groove respectively by rotating them to the right (clockwise).



- ⑥ Insert the filter connector.



- ⑦ Insert the filter cover into the groove respectively and close the filter cover.

- ⑧ Push the operation button to activate the water flow.

- ⑨ Upon replacement of a filter, foreign particles and remainders may be released for the first five liters of water. Allow the machine to run for a few minutes if possible before drinking, although it is not harmful to your health. Upon completion of releasing the initial five liters, you can select and use the ionic water of your preference.

Replace filters according to the filter replacement cycle notified by the voice announcement. Delay in filter replacement can cause the product to function improperly.

How to Replace Filter

- Upon expiration of the life expectancy of a filter, an audible notification of replacement request comes from the machine.

(The filter replacement audible notification is presented whenever the machine is operating with 70 liters left until expiration of the life expectancy of a filter.)

- ① Close the inflow valve of the machine before replacing a filter to prevent water leakage.
- ② Detach the left and right filter covers from the machine.



- ③ Detach the filter connector and disengage the first or second-phase filter.
- ④ Rotate the first or second-phase filter to the left to detach it from the equipment.

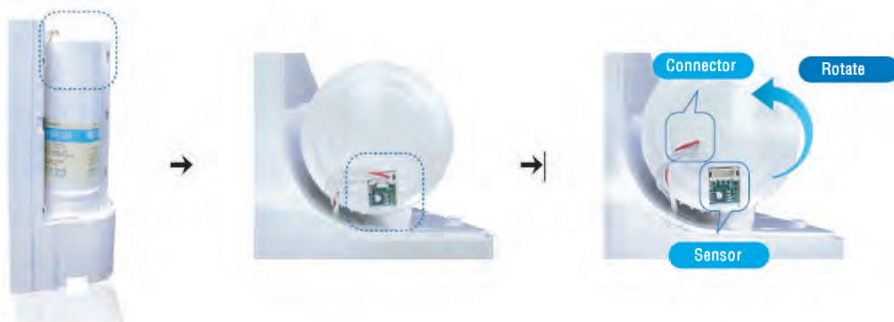

Installation



Do not install this product near heat appliances. Never place a candle or cigarette on this product. Otherwise, fire may occur.



Do not install this product on a sloped or uneven surface and do not apply excessive force or impact to this product, which may cause physical injuries and damage to the product.

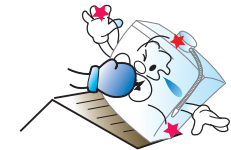

Do not connect source water to the hot water supply line. **CONNECT TO COLD WATER LINE ONLY** (At no time should the machine be connected to the hot water line)

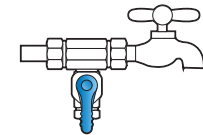

Install this product around the sink, allowing water to be drained into the sink.

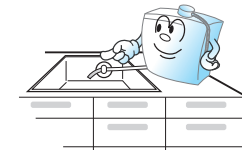

Install the acidic water outlet hose below the height of the product to be drained downward into the sink. Make sure the end of the hose is installed in such a way that it is less than 8 inches from the bottom of the product. Otherwise, product performance can be degraded, and residual water may remain unextracted.

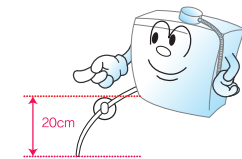

This product features a combination of EOS IonQuench's highly advanced technology, elegant design, and advanced electronic control unit, providing ease of operation and excellent performance.

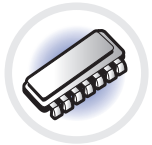

■ CPU embedded, fully automated system

Every motion of an apparatus for producing electrolytic water is controlled by semiconductor CPU that automatically finds an optimal operating condition using flow rates and water quality.



■ Automatic water outflow

Merely pressing the touch button allows you to extract water or stop the flow of water.



■ Voice announcement

Voice announcements for different functions and safety warning voice announcements ensure safe and convenient use.

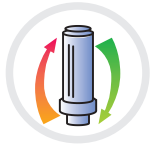

■ Filter replacement cycle display and announcement

This product is designed to warn filter replacement time intervals by the voice announcement and LCD icons.



■ Neat and Elegant Design

This product uses a compact and deluxe design that harmonizes with the kitchen decor.



■ Touch Button, RGB Color back light

The RGB color backlight on the touch Button allows you to distinguish alkali water from acidic water.

Automatic Cleaning Period Configuration (Recommended period : every 30 liters)

Change the mode into the function configuration mode by pushing and holding the mode button for about five seconds and push the mode button repeatedly until the letter "CL" appears on the screen and then set the automatic cleaning period to your preference using the "PURE(+)" or "ACID(-)" button.

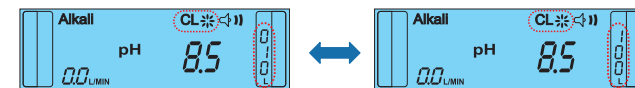

Step-by-step pH Configuration

Change the mode into the function configuration mode by pushing and holding the mode button for about five seconds and push the mode button repeatedly until the letter "Alkali" and "pH" appears on the screen then set the pH for each step to your preference using the "PURE(+)" or "ACID(-)" button.

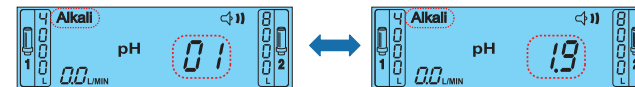

ALKALINE 1Step (1~19) ALKALINE 2Step (20~38) ALKALINE 3Step (39~57)
ALKALINE 4Step (58~69 : pH 10.0) (70~74 : pH 10.5) (75~76 : pH 11.0)

Step-by-step ORP Configuration (Configuration range: -50~-450), Acid water ORP(0~150)

Change the mode into the function configuration mode by pushing and holding the mode button for about five seconds and push the mode button repeatedly until the letter "alkali" and "ORP" appears on the screen then set the ORP for each step to your preference using the "PURE(+)" or "ACID(-)" button.

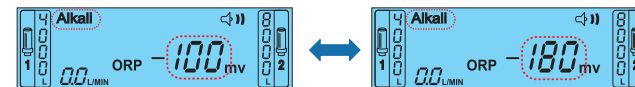

ALKALINE 1Step (-100 ~ -180) ALKALINE 2Step (-190 ~ -270)
ALKALINE 3Step (-280 ~ -360) ALKALINE 4Step (-370 ~ -450)

Warning : Save the changes by pushing the configuration button when you modify a mode configuration. The basic pH and ORP configuration is set for a released product and it is highly recommend not to change it randomly.

Configuration of Product Function

(The Genesis platinum machine comes manufactured with a preset control figuration, the control figuration does not have to be changed.)

LCD Back Light Configuration

Change the mode into the function configuration mode by pushing and holding the mode button for about five seconds and if the letter “ON” appears on the screen, the LCD is set to be constantly on. If you want to turn the LCD light on while a product is in use only, push the “PURE(+)” or “ACID(-)” button to select “OFF”.

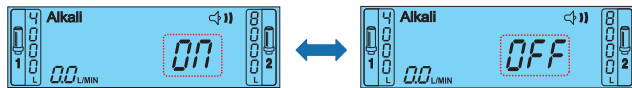

Volume Control (Recommended level : level 4)

Change the mode into the function configuration mode by pushing and holding the mode button for about five seconds and set the volume to your preference using the “PURE(+)” or “ACID(-)” button while the “Speaker Icon” flashes on the screen



Original Water pH Configuration (Configuration Range : pH 6.5~8.0)

Change the mode into the function configuration mode by pushing and holding the mode button for about five seconds and push the mode button repeatedly until the letter “Pure” and “pH” appears on the screen and then set the pH of the original water by pushing the “PURE(+)” or “ACID(-)” button.



Warning : Save the changes by pushing the configuration button when you modify a mode configuration. The basic pH and ORP configuration is set for a released product and it is highly recommend not to change it randomly.

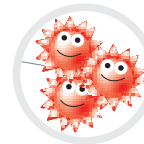

■ Electrolytic antibacterial system

The energy generated when extracting targeted water allows for inhibiting microorganisms from multiplying, and automatic cleaning allows for maintaining optimal conditions.

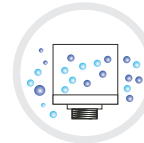

■ Advanced water purifying filter system

The highperformance primary filter and functional secondary filter enable the optimal purifying condition complying with tap water.

Safety Function

- In the event of suspension of water supply, a warning message is issued prior to stopping water outflow.
- This function prevents the electrolyte cell and power supply unit from being damaged due to overcurrent within the electrolyte cell.
- This function allows water outflow to stop automatically to prevent water from being wasted and to prevent water leaks arising from user's carelessness.
- This function allows you to set pH and ORP levels according to the amount of water inflow.
- This function allows you to distinguish from back light colors to prevent acidic water(yellow back light) from being taken.
- Auto Cleaning Function
- Voice Announcement Function

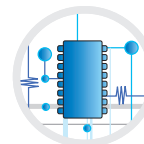

■ SMPS Type Power Supply

CPU monitors the power supplied to different types of parts, thereby ensuring this product is used in a stable manner.

Front

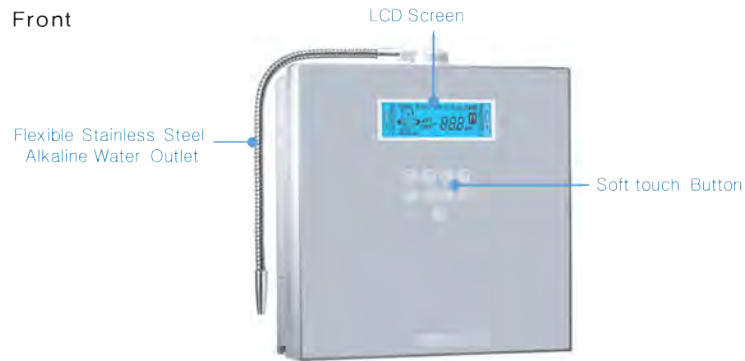

Back

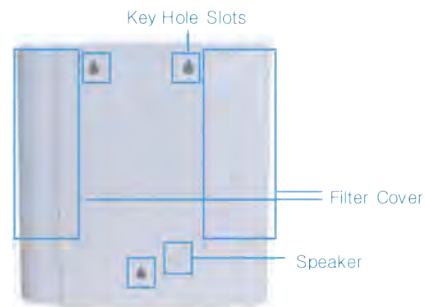

Bottom

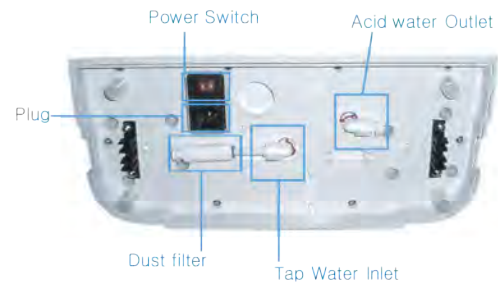

Operation of Alkaline Water

- Push the Alkaline Water button that corresponds to the step of your preference and then softly touch the operation button 
- If you want to control the Alkaline Water step while the product is in operation, push the Alkaline Water button that corresponds to the step of your selection. (You are able to change the Alkaline Water step while in use by pushing the corresponding Alkaline Water button, audible notification is provided upon completion of changing the step).

Operation of Acid Water

- Push the Acid Water button that corresponds to the acid step of your preference and then softly touch the operation button. (The acid step is categorized into four different steps with one step incremented for each action of pushing the acid button) 

Purifying Operation

- Push the purification button, followed by the operation button. 

Cleaning Operation

- If cleaning is activated, the cleaning icon on the LCD screen will be flashing and cleaning is conducted.
- When power is first turned on, the equipment is designed to perform an automatic cleaning for 30 seconds. (In cleaning state, the acid water flows out of the Alkaline Water exit while alkaline water drains out of the acid water exit)

 **Warning :** Do not drink the ionic water coming out while cleaning operation is in progress.

After installation, make sure to be well familiar with the operating methods.

Initial Use of Machine

- Place the machine on your selected location and connect the pipes (inflow/outflow). Make sure to check if there is any leak after completing the plumbing work.
- Connect the power supply, turn the machine on and open the original water valve to activate a water flow.
- During the initial installation or when changing the replacement filter, an automatic cleaning is performed along with a melody while ionic water flows out of the alkaline and acid water exits.

Warning : Do not drink the ionic water coming out of the drain tube while cleaning operation is in progress.
- Upon completion of the cleaning process, select the water with the appropriate pH (step 1 through 4) according to your use, purpose and preference.
- If you want to stop the operation of the machine, push the operate/hold button.
- From the previous use, you will have the ionic water according to the configuration that you set the last time you used the machine. However, after using the four-step alkaline water, it is automatically converted into the two-step alkaline water.

Measuring pH Density

- pH : the measure of the acidity or alkalinity of a solution.
- Pour 50 ml (or 2 teaspoons) of alkaline ionic water, acid ionic water, and neutral water respectively in each glass test tube and drop 3 drops of re-agent. Compare the color of each colorimetric paper.



The pH value may vary to some extent according to the water quality and water pressure.

Warning : Never drink the pH re-agent and test water. Store the pH reagent in a cool and dark place.

LCD Screen

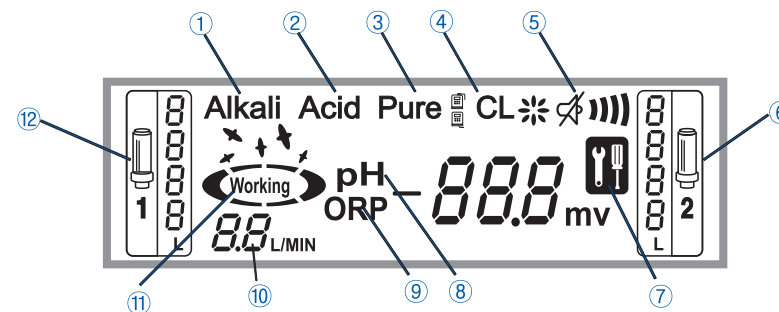

- Alkaline Water indication
- Acid Water indication
- Purified water indication
- cleaning indication
- Volume control
- Second filtering remainder indication
- Check indication when problem occurs
- Current pH indication
- Current ORP indication
- Water inflow amount indication
- Electrolyzing indication
- First filtering remainder indication

Touch Button

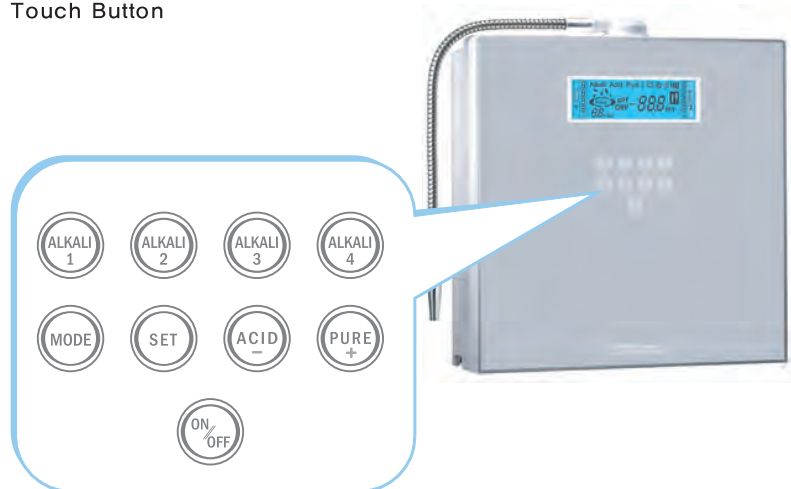

- ... → Alkaline Water button
1~4 step
- Mode button
Configuration of Product Function
- Set button
Save the changes
- Acid Water button &
Function configuration(-)
- purified water button &
Function configuration (+)
- ON/OFF operation button

Prior to installation, make sure to check the following fittings.

Installation of a tube in the wall-mounted faucet

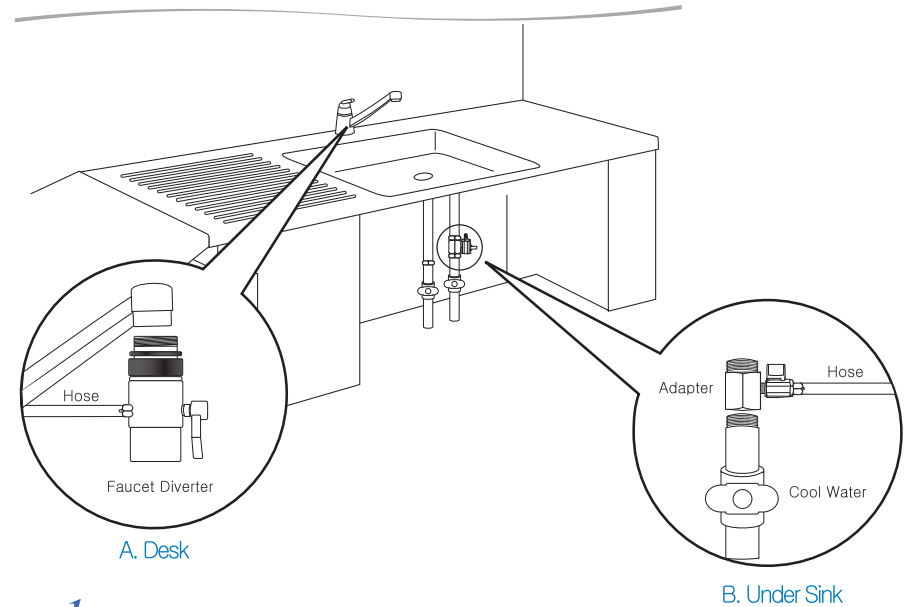

1. Lock the main valve on the water pipe.
2. Separate the tap from the water pipe.
3. Turn the adapter to allow it to be fitted in the water pipe.
4. Assemble the tap back into the adapter.
5. Connect the valve to the adapter before connecting the water inlet hose to the nipple.