

Owner's Operation Manual

U-BLUE

ALKALINE WATER IONIZER

Refinement of Alkaline Ionized water(Hexagonal & Hydrogen Water)



Warning: Incorrect installation and/or operation could void your valuable warranty.
Please protect your investment! READ THIS MANUAL CAREFULLY

Safety Precautions

If a break down occurs, do not make a repair by yourself. Contact the place of purchase or A/S center.

If your ionizer becomes submerged in water, unplug the power cord from the wall BEFORE removing the ionizer from the water. Failure to do so may cause electric shock!



NEVER attempt to repair or service the unit yourself. Contact your dealer. Attempting to do so will void your valuable warranty!

Do not use your ionizer at voltages other than specified. Do not plug in your ionizer where it will exceed the rating of outlet or electric wiring. Failure to do so can result in fire, injury and / or damage to yourself, wiring or ionizer!



NEVER touch the power cord or plug with wet hands. – this may result in electric shock!



Ensure the power plug is firmly and properly inserted into the outlet. – failure to do so may result in electric shock or fire!

Do not run hot water through your ionizer.

Do not clean by pouring water over or spraying the ionizer.

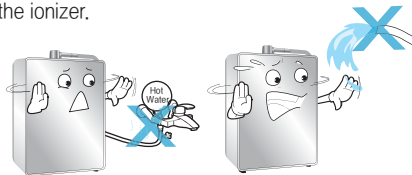

Protect your ionizer from freezing temperatures. Protect your ionizer from direct sunlight.



Unplug your ionizer if you plan not to use it for an extended period or turn off the main power switch on the back of the unit. Filter replacement may be necessary



Do not attempt to repair or service the unit yourself. Contact your dealer. Attempting to do so will void your valuable warranty!

Make sure to use your ionizer only with potable water which is suitable for human consumption.

DO NOT use your ionizer with well water, water with extreme hardness, high sediment or TDS levels without first consulting your dealer.



If the appliance makes strange or unusual noises or burning smells are detected, unplug the power cord immediately and contact your dealer to arrange service.



Do not close, bend, pinch, press or otherwise obstruct output ports or hoses.



pH Reagent Liquid Precautions

Do not expose the pH measuring reagent to extreme heat, flames or fire. It is combustible.

Do not drink the pH reagent liquid, put it in the eyes or apply to the body.

- If the liquid is ingested, induce vomiting immediately and call a doctor.
- If the liquid gets in the eyes, flush immediately and thoroughly with cool water; call a doctor.
- If spilled or dropped on your body, wash it off immediately.

Make sure to keep the pH reagent liquid tightly closed and out of the reach of children.

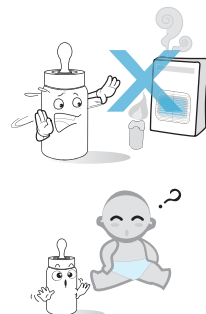

Some helpful tips

For storing your alkaline water, glass or ceramic is best. Always try and keep your stored water cool and away from direct sunlight. You can use plastic, but only use lexan (number7) or poly bottles (Nalge type). It is always best fresh out of the machine and ideal if consumed on a day-to-day basis.

Do not store alkaline water in stainless steel, bronze or aluminum containers.

Save the box and Styrofoam your ionizer came packed in. This will help if your ionizer needs to be transported at a later date.



Do not use an ionizer downstream of a sodium-based ion exchange softening system or Reverse Osmosis system without first consulting with your dealer.

Name and functions of parts I

■ Front

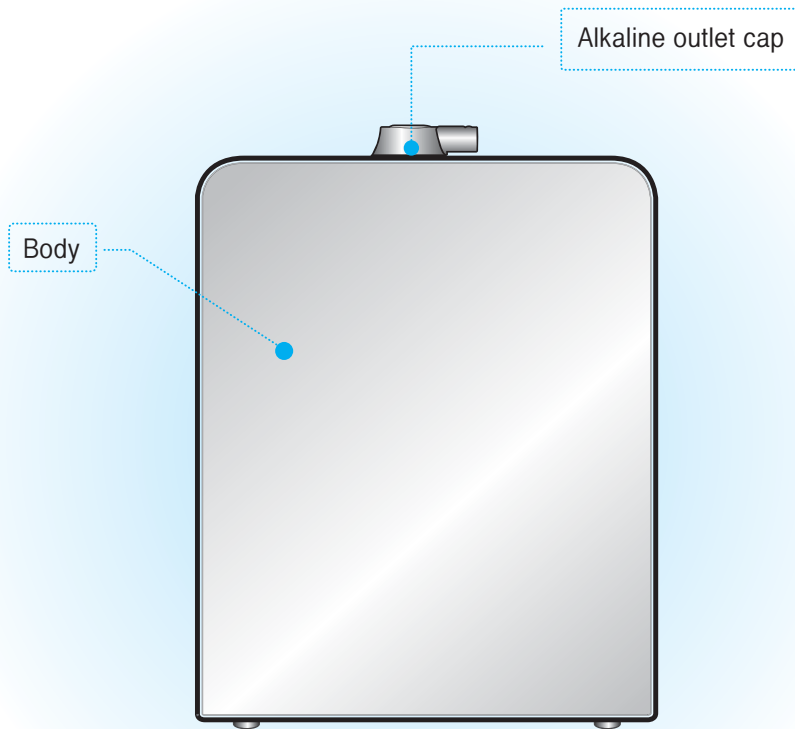

■ Back

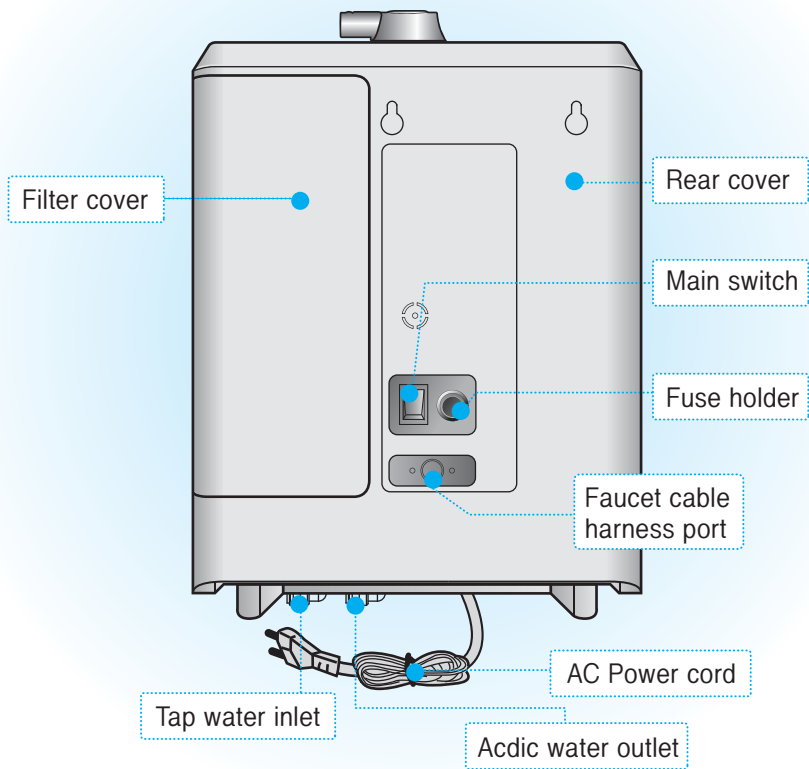

Name and functions of parts II

■ Faucet



■ Display

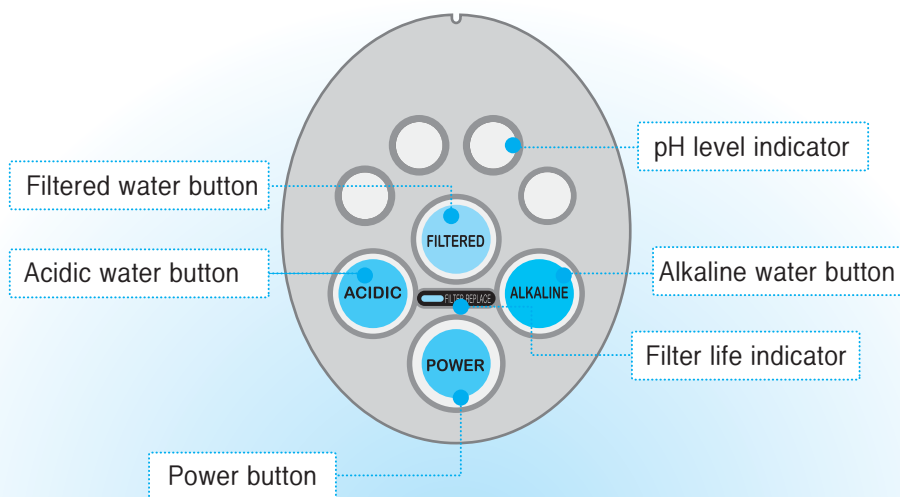

- **Power button**
Start and stops water flow into your ionizer.
- **pH level indicator**
This 4 of LEDs display will indicate which level(1~4) is selected.
- **Alkaline select button**
Used to select alkaline water and the desired level(1~4).
- **Acidic select button**
Used to select acidic water and the desired level(1~4).
- **Filtered Only select button**
Used to select filtered water Ionization is not functioning in this mode.
- **Filter life indicator**
Displays the current filter life used.
When the color change the Orange and flickers, it is time to replace your filter.

Accessories (Needed for faucet installation)

! Caution

Product Requirement :

Water pressure should be maintained at a constant rate, when the water pressure is too low, water cannot flow through the unit.

■ Accessories

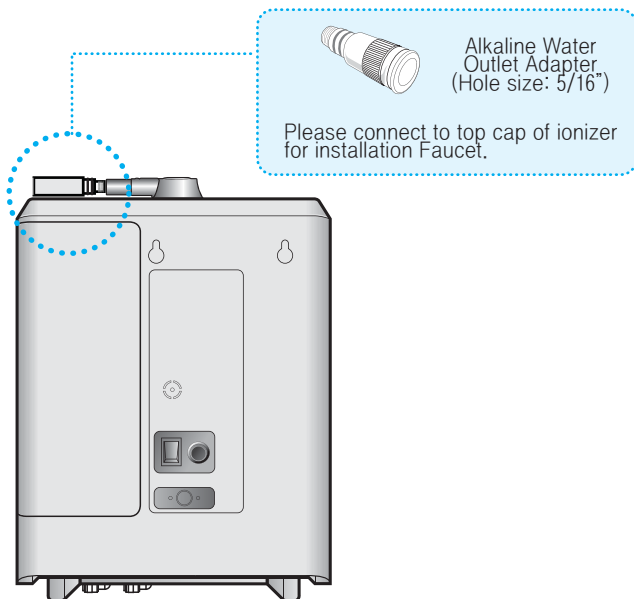
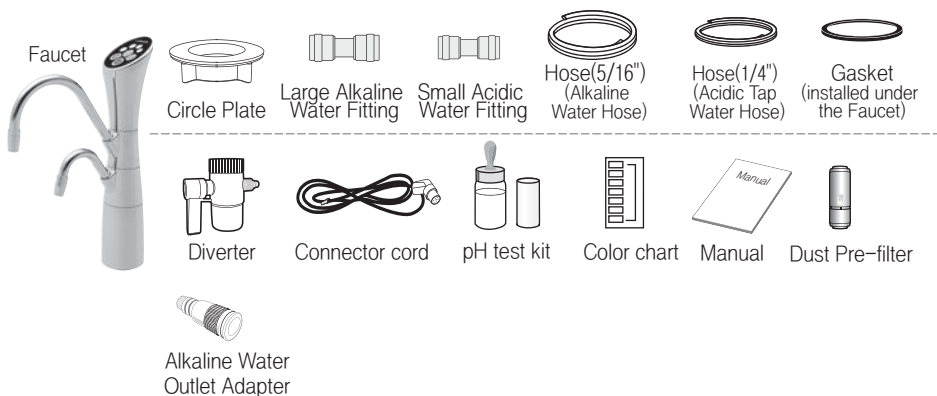

How to install the faucet

To connect the faucet

All the fittings are push in style fittings. To attach the hoses to any fitting, firmly insert the end of the hose into the fitting. Pull firmly to check to connection – you should not be able to pull the hose out. To release the hose from the fitting, you must push the spring loaded ring protruding from the end of the fitting while pulling the hose out.

WARNING: Incorrect installation could void your valuable warranty.

Professional installation is recommended.

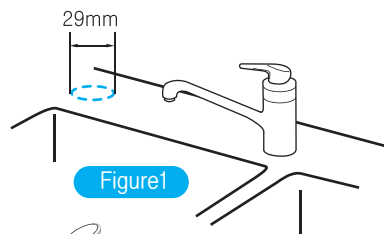

Figure1

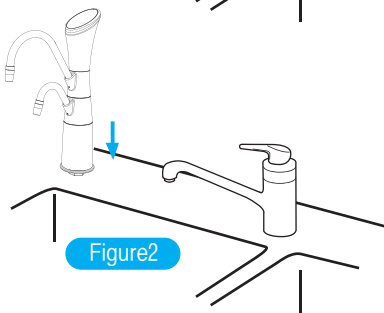

Figure2

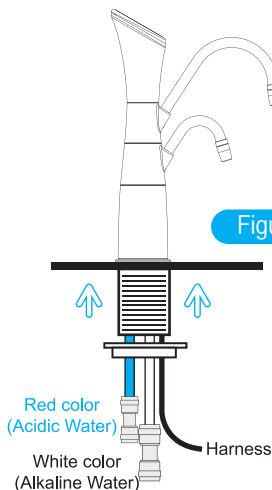

Figure3

- 1 Use appropriate tools to make 1.14in. diameter hole in the location where you will set up the faucet. Make sure the faucet location will allow both spouts to reach the sink.
- 2 Center the faucet in the hole properly over the gasket.
- 3 Once, centered secure the faucet to the counter by tightening the circle nut under counter until the faucet is secure and sufficiently tight.
- 4 After the faucet is fixed, connect it to fitting with 5/16 in hose(for Alkaline) like figure4. Check the hose whether it is inserted properly or not. Also, connect it with 1/4" hose(for Acidic) like figure4 and connect the faucet to the body with connector cord.

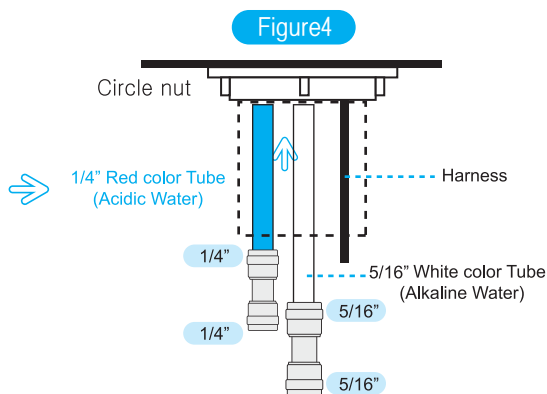
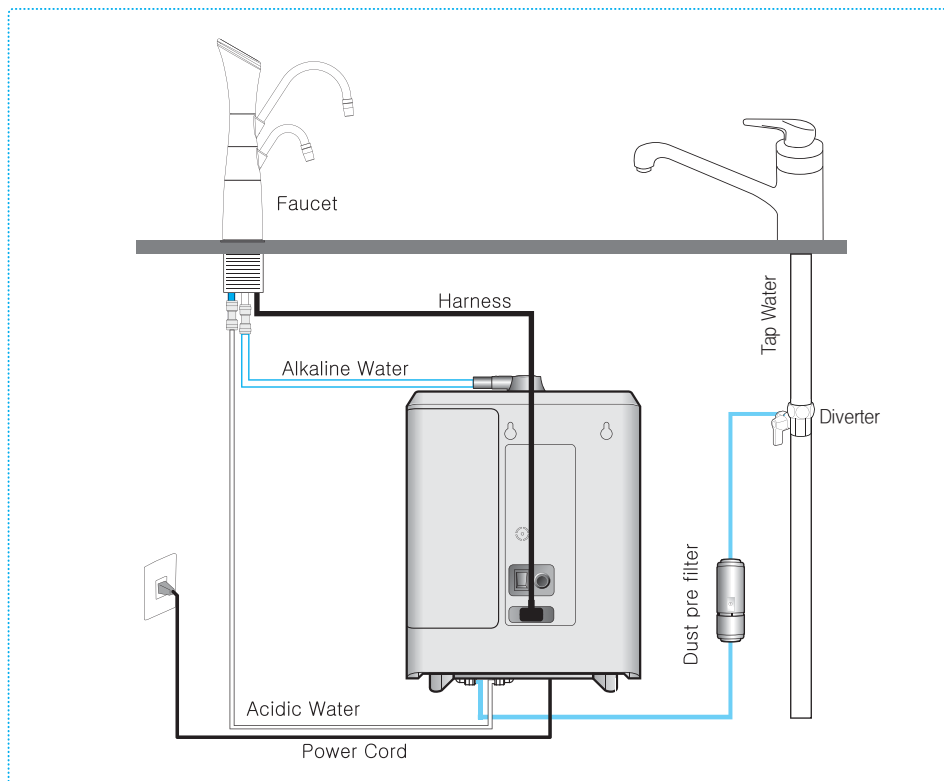

Figure4

How to install



- 5 Place the Ionizer in an appropriate place under your sink.
- 6 Connect the 1/4inch Acidic Water Hose to the small fitting on the Acidic Hose extending from the faucet to Acidic Water Outlet on the Ionizer. Pull firmly to check to connection You should not be able to pull the hose out.
- 7 Connect 5/16 inch Alkaline Water Hose attached to the Fitting of the faucet to the Alkaline Water Outlet on the ionizer. Pull firmly to check to connection – you should not be able to pull the hose out.
- 8 Connect the diverter between the Tap water pipe.
- 9 Install the dust pre-filter in the middle of 1/4 inch hose with the arrow pointed at the ionizer. Connect the 1/4 inch hose with dust pre-filter to Tap Water Inlet on the bottom of the ionizer. Pull firmly to check to connection you should not be able to pull the hose out.
- 10 Join the wire from the faucet to the Connect Wire(Harness). Plug the Connector Cord into the Connector Port on the top of the ionizer.

How to use

- 11 Connect the power cord into an appropriate outlet.
- 12 Make sure the outlet you plug your ionizer into is always live. You must use a non-switched outlet under the sink where you are installing the ionizer. Power to the ionizer must always be on.

Initial operation

- 1 Power up your ionizer.
Turn the power button on.
- 2 Turn the power button to the "ON" position on the back of the ionizer.
– The power button is ALWAYS left on.

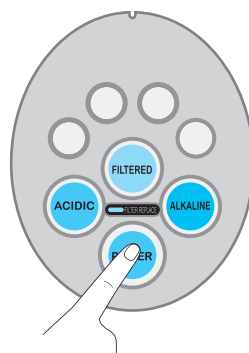

- 3 Water supply
Supply water by opening the water supply valve.

- 4 Start water flow through your ionizer.

– Press the "POWER" button on the top of your faucet to start the water flow.

NOTE: The water may initially come out discolored (light to charcoal gray) due to carbon particulates in the new filter.

– This is not harmful and is typical of all carbon filters. Allow the water to flow for 2–3 minutes in the "Filtered" mode and this will flush all the carbon dust.

To select Alkaline water

- 1 With the water running through your faucet then:
- 2 Press the "ALKALINE" button to select the desired setting from 1 – 4. The alkaline water will come out from the top spout. The display panel on the front of the faucet will show a blue Alkaline indicator and blue number corresponding to the level selected.
- 3 **NOTE :** Your ionizer will always "remember" the last setting used. If the previous selection was Alkaline Level 2, when you start flow through the ionizer next time you use the ionizer it will automatically process at Alkaline Level 2.

How to use

- 4 To select a different level, depress the "ALKALINE" button to move to next level until the desired setting level is achieved. The blue number will change accordingly.

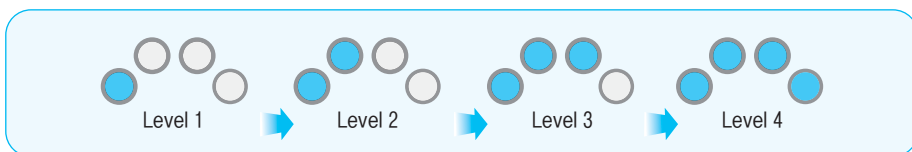
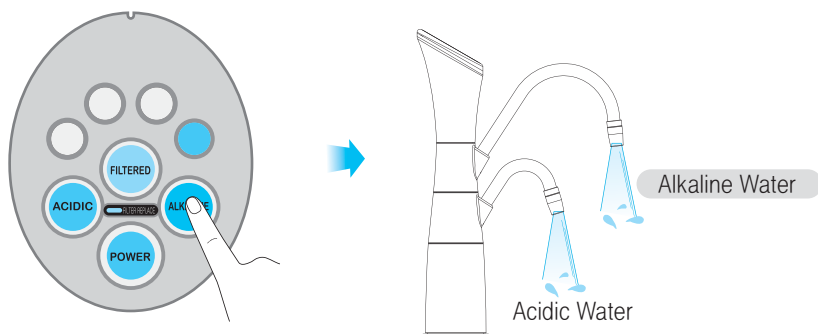

Alkaline water levels Note: pH levels will always vary with different source water.



Level 1

Weak Alkaline water

This level is used for initial consumption period (4–7 days). Let your body adjust slowly to this increase in pH.



Level 2

Weak to Medium Alkaline water

Move up to this level after the initial adjustment period. Adjust to this level for 3–4 days. Most people will drink at level 2 or 3.



Level 3

Medium to Strong Alkaline water

This is the most common level of alkalinity for drinking purposes. Some people may start to detect a strong change in taste.



Level 4

Strong Alkaline water

Generally, most people find this very strong tasting and with powerful detoxifying effects.

How to measure pH/ Wall hanger installation

To select Acidic water

NOTE : Acidic water is used except for drinking. **DO NOT DRINK**

- 1 With the water running through your faucet then:
- 2 Press the "ACIDIC" button to select the desired setting.
The display panel will show an orange LEDs corresponding to the level selected.
The Acidic water will come out from the top spout.
- 3 **NOTE :** Your ionizer will always "remember" the last setting used.
If the previous selection was Acidic Level 2, when you start flow through the ionizer next time you use the ionizer it will automatically process at Acidic Level 2.
- 4 To select a different level, depress the "ACIDIC" button to move to next level until the desired setting level is achieved. The orange number will change accordingly.

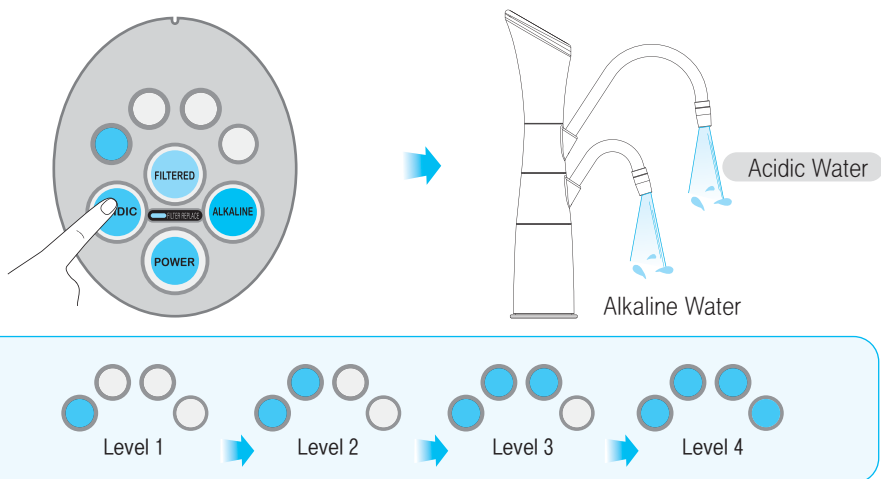

Descriptions of Acidic water levels Note: pH levels will vary with different source water.



Level 1
Weak Acidic water
Used for oral hygiene, mouth wash etc.



Level 2
Weak to Medium Acidic water
For skin care, as an astringent.



Level 3
Medium to Strong Acidic water
For cleaning in the kitchen.



Level 4
Strong Acidic water
For sterilization purposes.

How to use

To select Filtered Only water

With the water running through your faucet, press the "Filtered Only" button. The display panel will show a green symbol. The Filtered water will come out of the top spout.

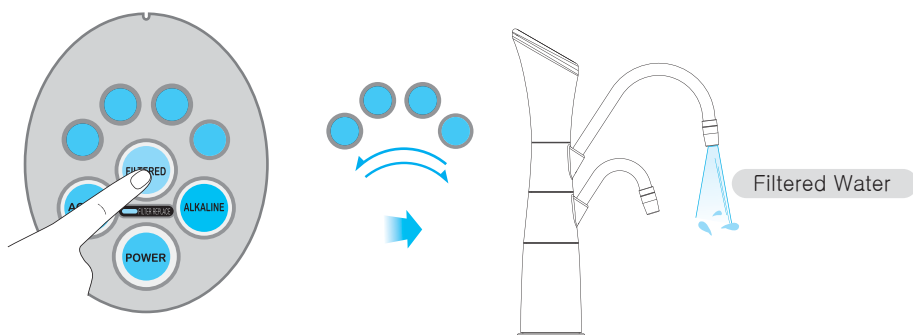

How to shut off the water flow from your ionizer

With the water running through your faucet then depress the power button. The water will stop and the display panel will go dark indicating the ionizer is in standby or "asleep".

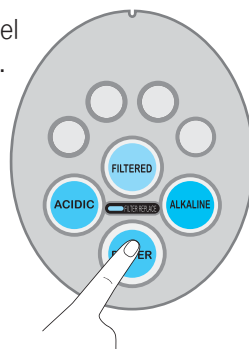

How to set your individual pH levels

User can regulate the electrical current of the water ionizer based on the water source.

- 1 Press the "FILTERED" button for 5 seconds on the faucet.

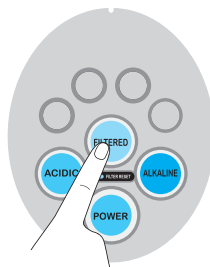

- 2 With the beep sound, the default setting level 4 appears on the pH level indicator of the display panel.
(You can select the desired setting from 1-7)

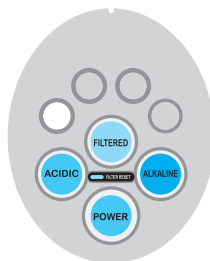

Ex) Level 4

- 3 Press the "ALKALINE" button to raise to the desired setting, and depress the "ACIDIC" button to lower to the desired setting.

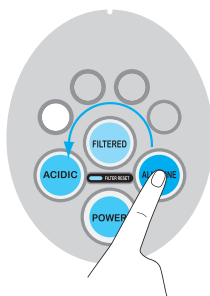

Raise (+)

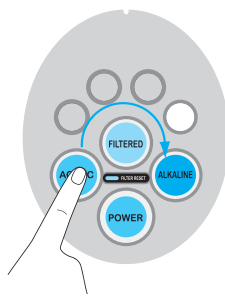

Lower (-)



- 4 To fix the setting you selected, depress the "POWER" button on the faucet.

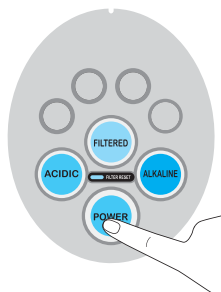

How to replace the filter

IMPORTANT! Stop water flow prior to filter replacement.

- 1 When the LED filter life indicator lighting, it is time to replace your filter.

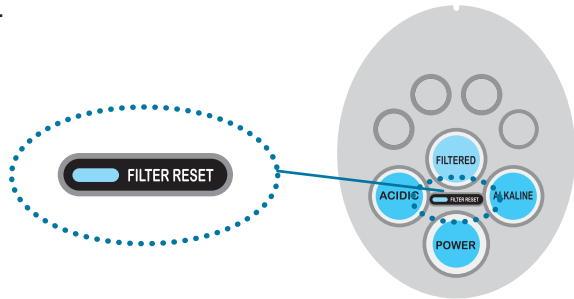

- 2 Open the filter housing cover. slide the cover to the left and remove it.

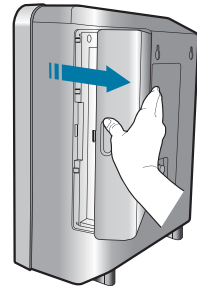

- 3 Remove the expired filter.
 - Taking hold of the filter securely with your right hand, press the filter firmly down against the spring loaded mechanism (figure1) to disengage the top of the filter and then pull it toward you (figure2) and up to remove it.
 - The upper part of the filter is separated from housing by pressing firmly down. Once you have engaged the spring loaded mechanism, you can then easily remove the filter from the main body by pulling it toward you.

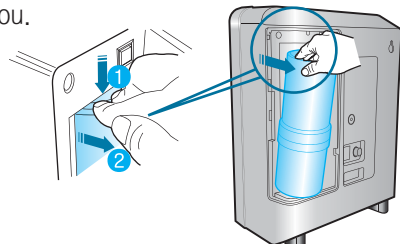

4 Insert the new filter into the compartment.

- Remove the plastic caps covering both ends of the new filter.
- Seat the large opening on the bottom of the filter cartridge onto the base in the center of the filter cushion.
- Push the filter down and into the housing compartment ensuring the opening at the top of the filter is seated properly into the fitting at the top of the housing.

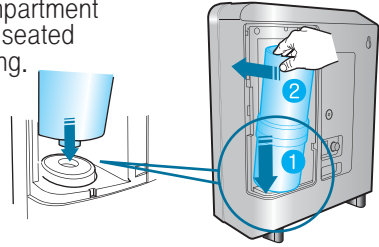

5 Check for leakage by running water through your ionizer before replacing the housing cover.

6 Flush out the carbon dust.

- The water will initially come out discolored (light to charcoal gray) due to carbon particulates in the new filter.
Allow the water to flow for 2-3 minutes in the "Purified" mode and this will flush all the carbon dust.

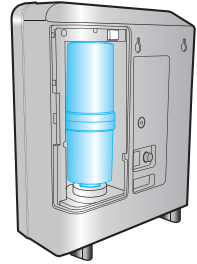

Immediately after filter replacement, the water will come out black and unclear due to the activated carbon particulates in the new filter but will become clear momentarily. (It is not harmful.)

7 Press the reset button(Alkaline Button) located on the top of the faucet, and depress for 4 seconds.

NOTE: When filter life indicator is reset, and also when machine is new, the "FILTER REPLACE" light will not be flashing.

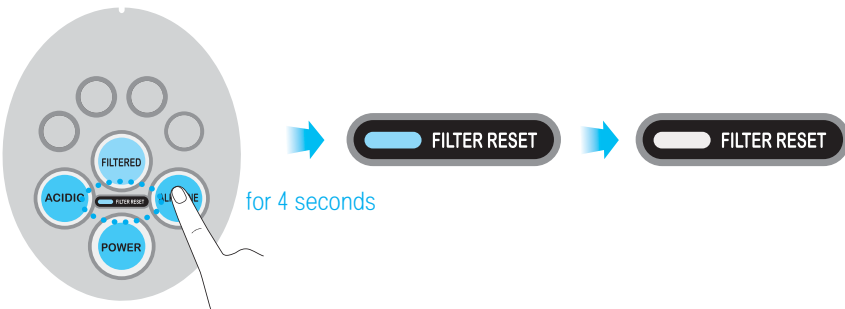

Filter Composition

Composition of filter(optional)

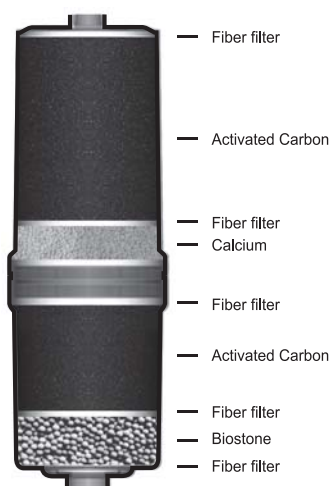

High Performance Carbon Filter

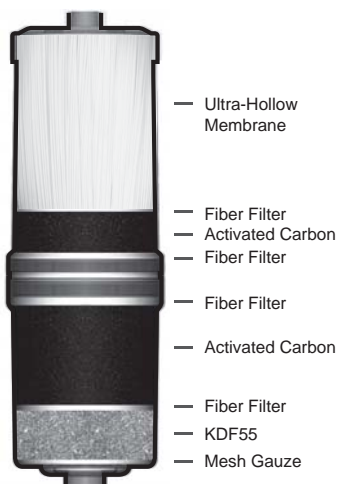

High Performance UF Filter

Caution



It is better to use UF(Combined hollow fiber membrane) filter initially, with power off, after making water of 20 l (1 kgf/cm²) flow for approx. 5 minutes at minimum without fail, in order to eliminate hydrophilic substance.

(If water pressure is below 1 kgf/cm², a time longer than 5 minutes is needed)

Recommended period for changing filter

Effective period of use of filter may differ greatly depending on season and usage environment (quality and pressure of water and amount of use)

Reference

Change filter when follow phenomena occur even filter change icon does not flicker.

- When water flows little because filter is blocked due to heavily contaminated water
- When water smells because seriously contaminated water is flowed in
- When lots of foreign substance in water (turbid water, invisible substance) is eliminated in a short time
- When reusing it after you do not use it for a long time

How to measure pH

How to measure pH

Important Note: Water quality and mineral content vary greatly in different localities and will directly impact performance of your ionizer with respect to pH.

- 1 Fill one of the test container provided about 1/4 full with alkaline, acidic or purified water.

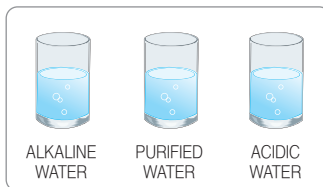

- 2 Drop 2 or 3 drops of the pH reagent into the container and shake it.

If the reagent and water are not mixed well, the correct result may not be and shake it.

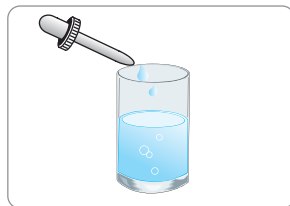

- 3 The pH value is determined by matching the color the pH color chart provided.

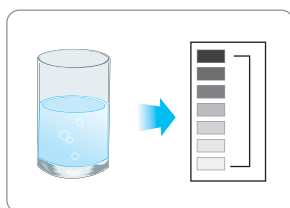

! Caution

- DO NOT consume water containing reagent.
- Keep the pH reagent liquid, color chart, and OPEN FLAMES!
- For contact with eyes, flush liberally with fresh water, seek medical help.
- If ingested, induce vomiting, seek medical help.

Trouble Shooting Guide

Abnormal condition	Cause(s)	Resolution
The Function Display Panel does not come on.	A power plug is not properly inserted, or it is inserted into a faulty outlet.	Properly insert power plug into a correctly functioning power outlet
	The fuse is blown. The fuse is not inserted properly.	Replace the fuse. A spare fuse is located in the rear-panel fuse holder. (3A / 250V fuse)
pH test shows alkaline water color as neutral (7) while acidic water color gets yellow (6). This is normal if initial pH is 6.5	Faulty or evaporated reagent: alkaline / acidity are always produced in inverse proportion. Therefore, showing an acidic color means inversely that alkaline water has to be generated from the unit. Lack of alkaline color can result from a chemical reaction where carbonic acid in water evaporates some test reagent elements.	Test pH value on level 3 or 4 water; replace reagent.
Power supply is suddenly cut off while operating the unit.	Elevated level of salt in the water or high TDS; extended operation at high pH; sudden change in electrical current. In these cases your machine will shut down automatically to protect the electrodes and circuitry.	Wait – the unit will become operational again after about one hour. Your Machine has a safety mechanism built-in to protect the electrodes and circuitry. This mechanism will shut the Machine down automatically. This mechanism protects the unit from overuse or excessive electric current.
Low output of alkaline water from the unit.	Filter is clogged. Premature clogging may be caused by sudden drop in water quality and an influx of sediment or other contaminants, which stress the filter.	Replace your filter. Clean Pre-filter
	Low pressure in your household plumbing.	Ensure water supply valves are fully open. The water pressure in house may be too low.
	The input hose is bent, kinked or otherwise restricted.	Straighten the bent hose.

Abnormal condition	Cause(s)	Resolution
The Function Display Panel / display indicators do not come on even after turning the tap on.	Faulty PCB (Printed Circuit Board)	Immediately unplug the unit and contact Customer Svc. arrange service.
Strange smell from Alkaline water.	Expired filter from ordinary use or premature clogging due to contaminants in water quality.	Replace your filter.
	Sudden change in water quality with elevated level of Sulfur (not Chlorine). Elevated Sulfur levels are observed in some areas during summer months. These levels fall within safe drinking water standards, yet will cause a reaction with ionized water causing a unique smell.	Select lower pH level (1~2). If still present, filter replacement may be necessary.
Water appears murky; white snow like particles in the bottom of your glass.	You have high hardness (calcium primarily) in your water. The white is extracted CaCO_3 (Calcium carbonate). After CO_2 in water is bonded with Ca where elevated levels of CO_3 exist in your water. In water where elevated levels of CO_3 exist, what you see after ionization is CO_2 in the water bonded with Ca.	This is calcium! It is not only harmless, but actually good for you. Remember the Machine separates and condenses the alkaline minerals and this is what you are seeing. You can lower the setting (1~2) and reduce this effect. Typically this only occurs in hard water areas. add a softening pre-filter
At first no smell, but then smell from the alkaline water about one hour after.	Your water bottle or receptacle is foul and needs cleaning. Contamination mixes with alkaline water when filling your bottle. Expired filter.	Clean your bottle or receptacle. Try selecting lower pH level (1~2). Replace your filter. Clean container with vinegar
Water leakage from the filter cartridge housing.	Filter not installed correctly into filter housing.	Remove your filter and reinstall it properly following the filter replacement instructions. Increase the quantity of source water inflow.
No acid water flow from the acidic output port.	Acidic output hose is bent, kinked or otherwise restricted.	Straighten the bent hose; increase water flow from supply.

Product Specification

Product Specification

Product Manufacture Permission Number	No. 610 by KFDA (Korea Food & Drug Administration)
Feature	Ion Water Generator
Model	U-BLUE
INPUT Voltage	AC 120V or 240V, 50Hz~60Hz
Power Supply	SMPS
Power Consumption	250W
Overall Dimension	260 x 350 x160 (WxHxD) mm
Applicable Water Inflow Pressure	0.7~5kgf/cm ²
Applicable Water Temperature	5~30℃
Unit Operation Type	One Touch Automated Ionization Start
Electrolysis Method	Continuous Electrolysis
Electrode	7 Plate (Platinum over Titanium)
Electrolysis Capacity	DARC system (3.5L/min. at 3.5kgf/cm ²)
Electrolysis Setting	Alkaline (4level) / Purified Water / Acidic (4level)
Cleaning	Auto Reversing Cleaning
pH Value	pH 4.0(±0.5)~10.5(±0.5)
Filter Replacement	Easy Replaceable Cartridge
Filter Composition	Activated Carbon Filter, UF Membrane Filter(optional)
Filter Life	Approximately 6months (20liter/day)
Filter Life Indicator	LED Module Indicator
ON/OFF Valve	Solenoid Valve

Protection type and class against electric shock : Class II device, Type B applied part

Warranty card

WARRANTY CARD

1.Warranty Detail

This product passed the precise inspection under strict quality control. In case the product is found to have any defect in production or to get any spontaneous mechanical malfunction within the warranty term, return the unit to our sales agency, distributor or our service center along with this warranty card for repair free of charge.

2.Warranty term

12 months from a purchasing date.

3.Exception to warranty

Expiration of warranty terms.
Defect caused by a natural disaster.
Damage or malfunction resulting from misuse.

Model	U-BLUE
Purchasing date	()th Day, ()Month, ()Year
Warranty term	Till()th Day, ()Month, ()Year
Purchaser name	
Address	
Distributor Name	
Address	

- Fill in this warranty card upon receipt of new unit.
- Receipt can be in force as warranty card.



U-BLUE

ALKALINE WATER IONIZER

IONIA

address. 163-12, Dodang -Dong, Wonmi-Gu, Bucheon-Si, Gyeonggi-Do, Korea 14522

2016.11